

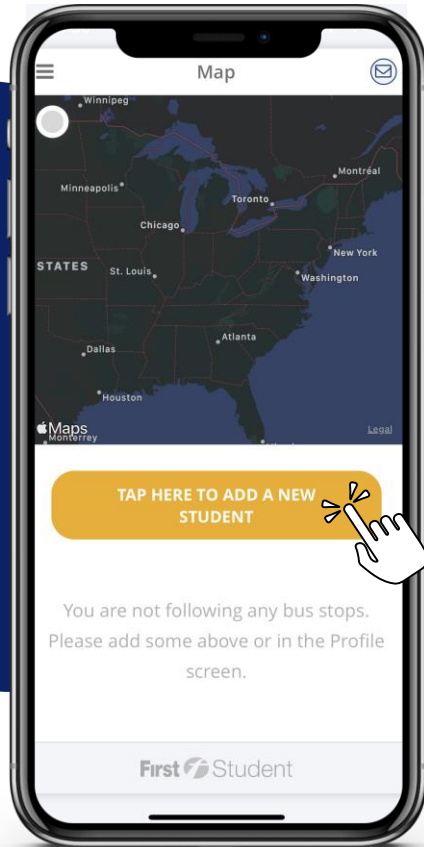

**Step 1:**  
Download app, Register  
& Log-In



# FirstView® Self-Guided Tools



## Step 2:

Click the yellow message box to add your first student, or you can click profile and “Add a Student” in the app menu



# FirstView® Self-Guided Tools

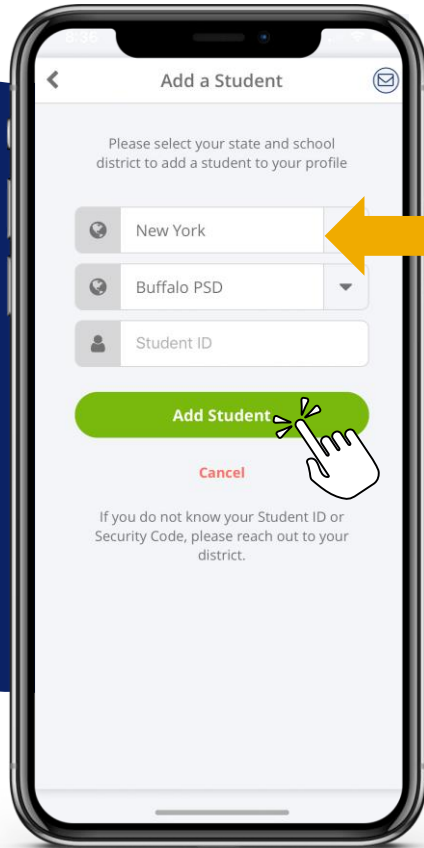

## Step 3:

- Select your state and school district from the drop down
- Add your Student ID\*
- Click 'Add Student'



\* If you do not know your student ID, please contact your school district.

# FirstView® Self-Guided Tools

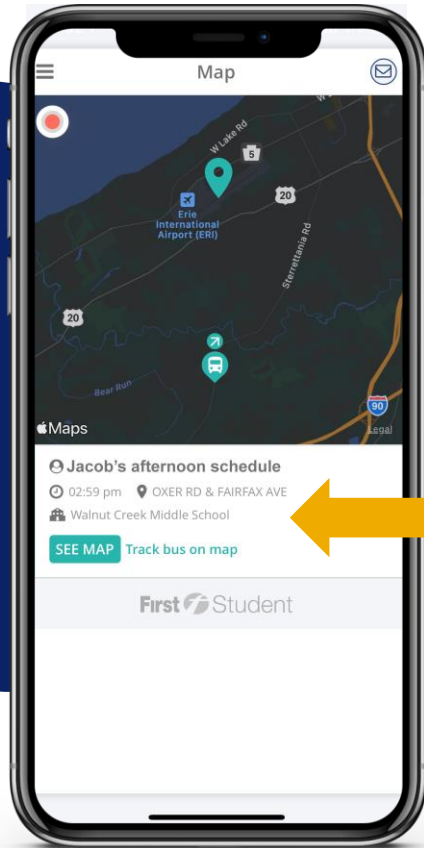

**Your student is added!**

Your student's stop information is now displayed on the map for tracking



# FirstView® Self-Guided Tools

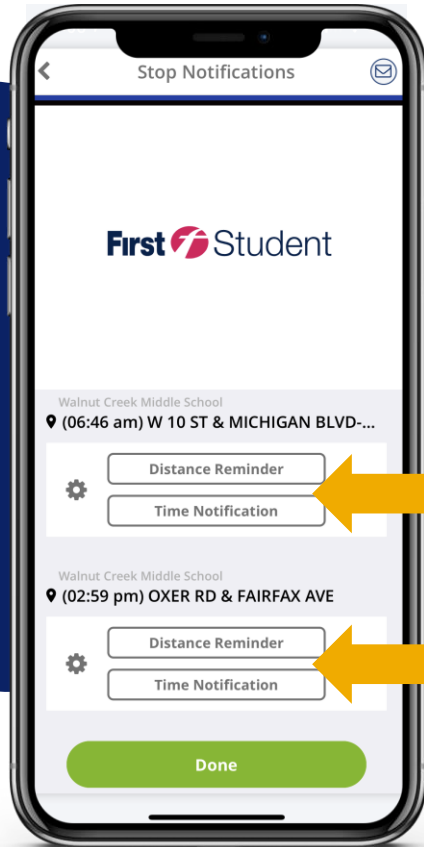

## Setting Up Alerts

Setup optional alerts for your student's routes. These can be added from the profile section and selecting your student's name under 'Student Stops'

